

micstar

In-ear Headphone with Mic

- Operating instructions (English)
- 使用說明書(繁體中文)

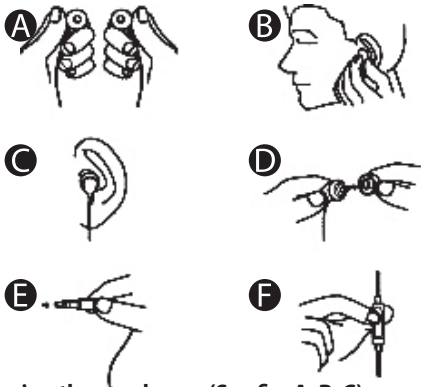

Wearing the earphones (See fig. A, B, C)

1. Determine right and left earphone according to micsatar's unique color identification design – Left earphone is with gray earpiece/cable & Right earphone is with black earpiece/cable.
2. Insert the gray earpiece into your left ear and black earpiece into your right ear, as in the illustration.

Precautions

1. Listening to music for an extended period of time with earphones might impair your hearing and do not use them when riding or driving for traffic safety.
2. When answering calls during riding and driving, for the sake of your safety, wear the earphones over a single ear instead of both to answer and use.
3. Do not impose heavy objects or pressures upon the earphones, which may be distorted during extended period of storage.
4. Earphones may be aged due to storage or use for an extended period.
5. Put the Earphone away after use and children below 3 are prohibited from using them.

如何佩戴耳機(圖A, B, C)

1. 根據micsatar獨特的顏色識別設計確定左右耳機，左耳機是灰色耳塞、灰色耳機分線，右耳機是黑色。
2. 將灰色耳塞、灰色耳機分線配戴於左耳，黑色耳塞及耳機分線配戴於右耳。
3. 將耳塞完全塞入耳道，並調整配戴的舒適度，耳塞沒裝戴好時，會影響到低音的表現。

如何更換耳塞(圖D)

1. 根據自己耳朵的大小，選擇適合的尺寸(大/中/小)，更換的方式如圖所示。
2. 從耳塞大的圓測面剝離，輕取下現有的耳塞。
3. 將更換的耳塞按下滑動、固定到位，直到感覺與出音孔完全固定。
4. 耳塞髒污時，可以取下以溫和的清潔劑清洗。

3. Be sure to wear the earphones completely inside the ear canal. Adjust the earpieces to fit snugly in your ear. Otherwise, it might affect the low-bass sound performance.

How to install the earpieces correctly (See fig. D)

1. If the earpieces do not fit your ears, try ones of other size (S/M/L). Installation is as shown in the illustration.
2. Remove the earpiece from the earphone gently.
3. Install the earpiece with suitable size back onto the earphone. The earpiece will be installed in place to have snug fit with the earphone speaker.
4. Clean the earpieces with a mild detergent solution if needed.

How to plug/unplug the stereo plug (See fig. E)

Hold the stereo plug firmly to plug and unplug. Do not pull the cord directly.

How to use the microphone control box (See fig. F)

1. When listening to music, the ringtone will sound in the earphone in case of any incoming call.
2. You may pause the music and switch to answer calls and talk freely by tapping the control key with a finger.
3. When the call ends, if the other party hangs off first, music play will automatically resume and if you hang off first, you can resume the music play by tapping the control key and continue to enjoy.
4. When listening to music, tapping the control key once can pause music while tapping twice can skip to play the next music.

如何拉拔插針頭(圖E)

手握插頭把手進行電線的插入或拔除，不可以直接拉電線拔除插頭。

如何使用麥克風控制盒(圖F)

1. 當聆聽音樂時，若有電話打入，耳機會響起電話的鈴聲。
2. 手指輕按控制鍵一下，就可以暫停音樂的播放轉換到電話的接聽與對談功能，讓你暢所欲言。
3. 通話結束時，如果對方先掛斷電話，將會自動回覆音樂的播放，若是自己先掛斷電話，只要手指再輕按控制鍵一下就可以恢復音樂的播放，繼續享受你的音樂。
4. 在聽音樂時，按一下控制鍵可以暫停音樂的播放，連續按兩下可以跳播下一曲音樂。

注意事項

1. 佩戴耳機以高音量長時間收聽音樂時可能會影響你的聽力，為了交通安全請勿在騎車或駕車時使用。
2. 騎車或開車接聽電話時，為了你的安全，請不要雙耳配戴耳機接聽，請以單耳配戴耳機接聽、使用。
3. 請勿在耳機上放置重物或施加壓力，否則在長期存放中會造成耳機變形。
4. 耳塞可能會由於長期存放或使用而老化。
5. 使用後請妥善收藏，禁止3歲以下孩童使用。