

Installation Guide

- To ensure using the stand correctly and safely, please read this manual carefully before installation.
- This model is recommended to be used for 55-86 inch interactive flat panel.
- Maximum load capacity: 100KG.

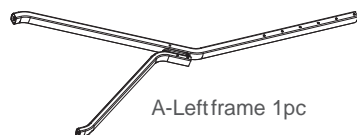

Bill of materials



A-Leftframe 1pc

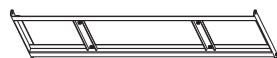

C- Wall mount 1pc



E- Castors 4pcs

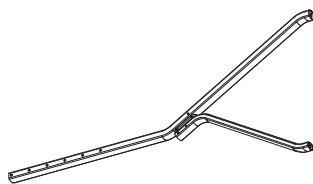

B- Rightframe 1pc



D- tray 1pc



F- Wall mount bracket 2pc*
**NON INCLUS
A RAJOUTER**

M8 screw	M8x25mm	14pcs	
M12 spring washer		4pcs	
M6 screw*	M6x130mm	2pcs	
Phillips screwdriver (self-provided)		1pcs	
Adjustable wrench (self-provided)		1pc	

Note: "*" indicates that due to different model, some models may contain this accessory.
Please refer to the actual situation

Installation steps

Step 1

Adjust the wheel to the brake state and screw it into the frame (Figure 1).

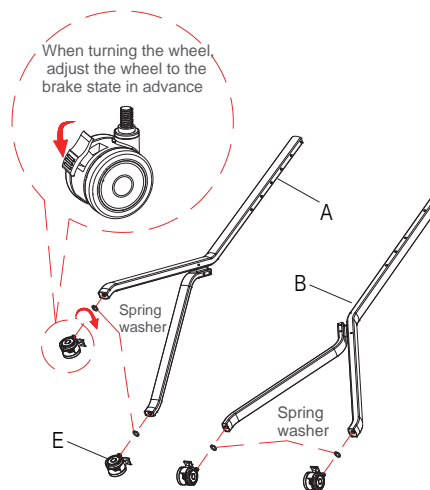

Figure1

Step 2

Attach the wall bracket to the end frame (Figure 2).

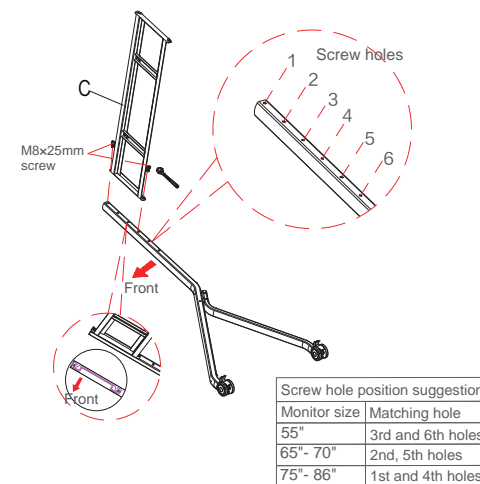

Figure 2

Step 3

Attach the other frame on the other end of the wall mount (Figure 3).

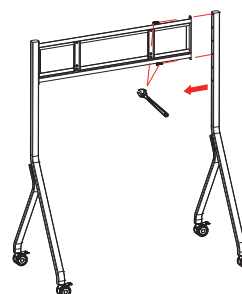

Figure 3

Step 4

Assemble the tray between the two frames (Figure4).

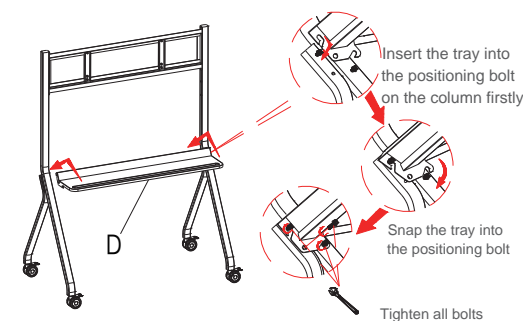

Figure 4

Step 5

According to the actual requirements of the IFP, lock the wall mount bracket on the IFP (Figure 5).

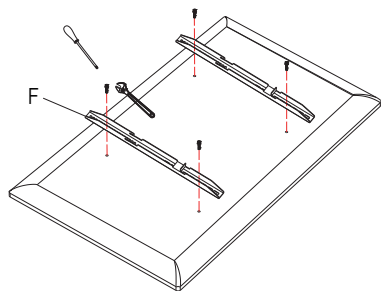

Figure 5

Step 6

Hang the IFP on the wall mount and lock the safety screw of the wall mount bracket (Figure 6).

Make sure the brakes are locked. This step requires at least 2 professionals to complete.

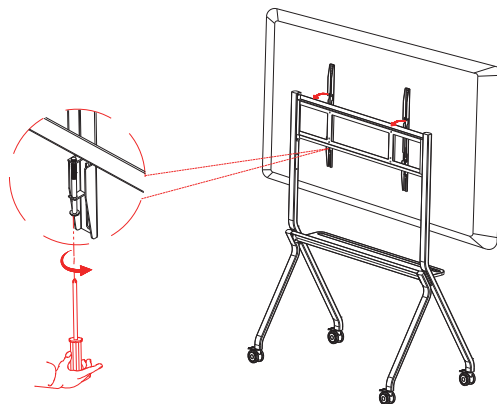

Figure 6

Step 7

Done, refer to the following figure.

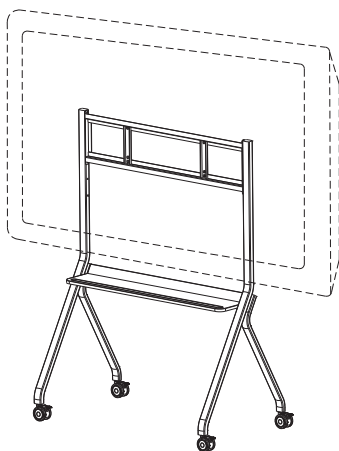

Figure 7

Remarks:

In some cases, the IFP's VESA bracket couldn't match with the original wall mount of the stand, it needs to be installed with the wall mount together.

Following is the installation process:

- 1 Lock the other wall mount onto the original one.

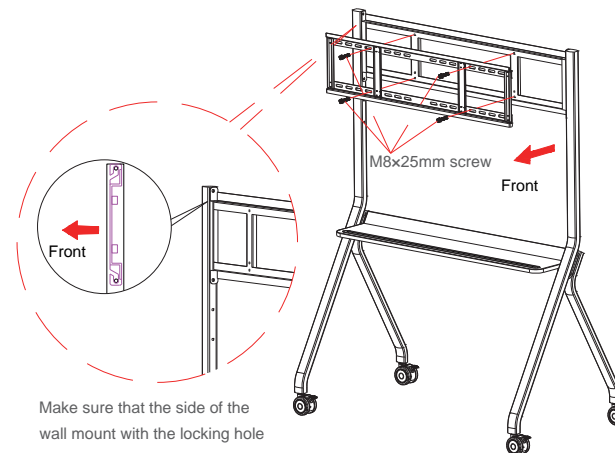

Make sure that the side of the wall mount with the locking hole is front

- 2 Mount the IFP on the newly installed wall mount and lock safety bolts.

